

782 BEECHWOOD AVENUE, VALLEJO, CA 94591

3 BD | 1 BA | 1,020 SQ. FT | 5,227 SQ. FT LOT

OFFERED AT

\$530,000



To get listing and finance info about this property,



text LIST11346759  
to 800.701.6509

Message and data rates may apply

OR, scan  
this code



## ABOUT THIS PROPERTY

This beautiful East Vallejo home is on a lovely tree lined street. The kitchen was updated less than three years ago. It features stainless steel appliances, subway tile backsplash with quartz counter. It has eat in kitchen area. There are laminate flooring throughout home. Two bedrooms have sliding glass doors that lead out to the large backyard, great for entertaining. Enjoy sitting in backyard under the covered patio that has a fan to cool you off during those warm days. The exterior of the home has been recently painted. You have to love the large front porch to sit and engaged in the sunsets and sunrises. This home is so well kept.

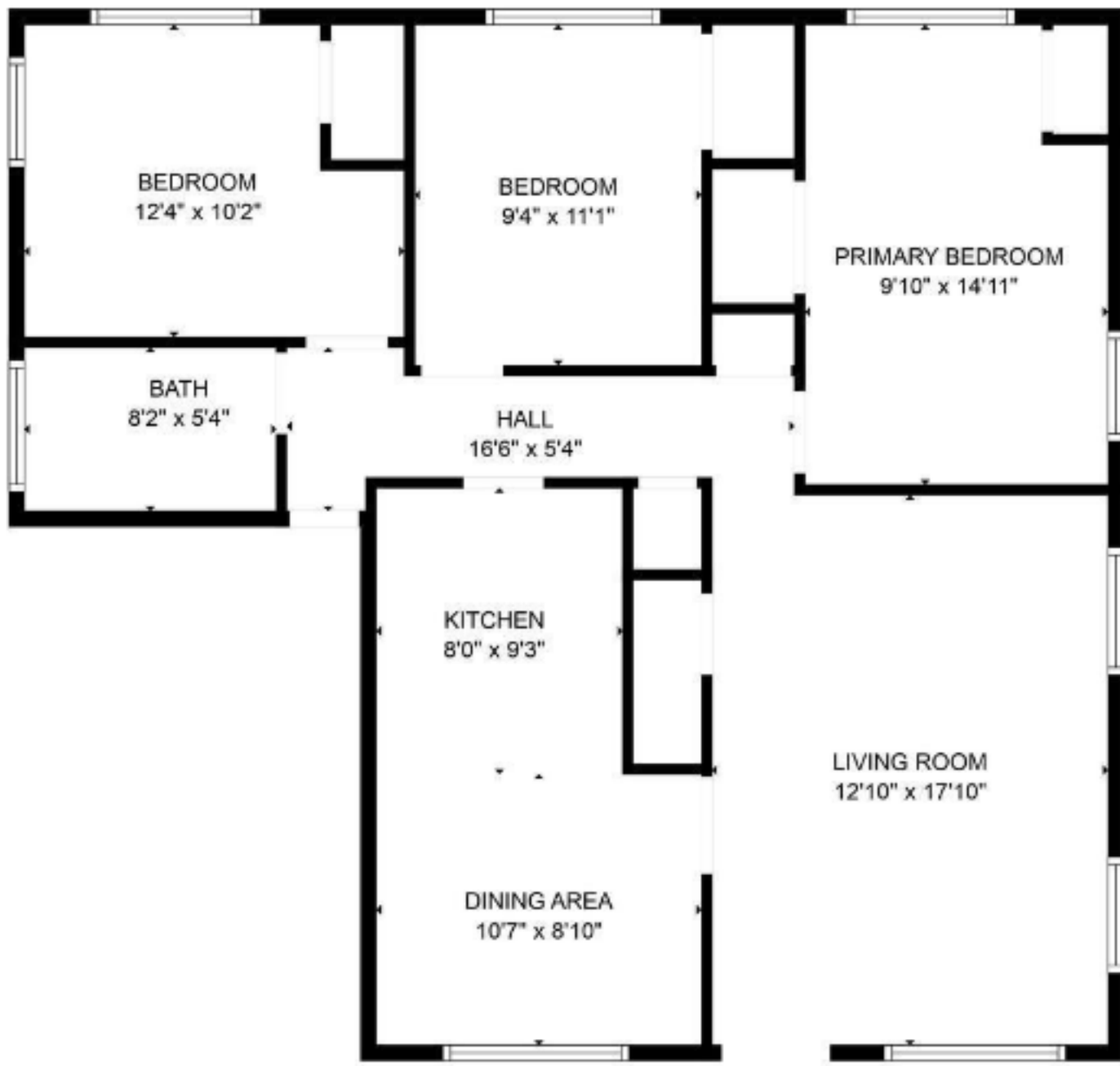

**ROBERT COLLINS JR**

The Sayles Group  
DRE# 01465394

m: (707) 653-0582

e: robert@saylesgrouphomes.com

w: robertcollinsrealty.com



1710 Tennessee St, Vallejo, CA 94590



**CAROLINE DADESHO**

Loan Officer  
NMLS# 198333

m: (209) 606-2629

e: caroline@empirehomeloans.com

w: www.empirehomeloans.com



4401 Hazel Ave. Suite 135, Fair Oaks, CA 95628  
Branch NMLS# 1839243

ListReports



© 2025 Empire Home Loans | Company NMLS: 1839243 | CA DFPI/CFL Lic: 60DBO-98315 | CA DRE Lic: 02086593 | AZ Lic: MB-1012019 | 4401 Hazel Ave., Suite 135 Fair Oaks, CA 95628 | https://www.nmlsconsumeraccess.org/EntityDetails.aspx/COMPANY/1839243 | Equal Housing Opportunity.





VERY CONVENIENT

This home is in a **very convenient** area. Some errands in this location require a car and most major services are within **1** mile.

- GROCERIES  
0.3 MI
- MEDICAL  
0.4 MI
- ATM  
0.4 MI
- CLEANERS  
0.4 MI
- COFFEE  
0.4 MI
- GAS  
0.5 MI
- PHARMACY  
0.6 MI
- GYM  
1.3 MI
- MOVIE THEATER  
2.2 MI



SCHOOLS IN YOUR AREA

The assigned schools are **average** for the area. There are also **8** private schools and **7** charter schools within **5** miles.

- 3** RATING  
K-5 STEFFAN MANOR ELEMENTARY SCHOOL  
ASSIGNED
- 6** RATING  
6-8 HOGAN MIDDLE SCHOOL  
ASSIGNED
- 5** RATING  
9-12 JESSE BETHEL HIGH SCHOOL  
ASSIGNED

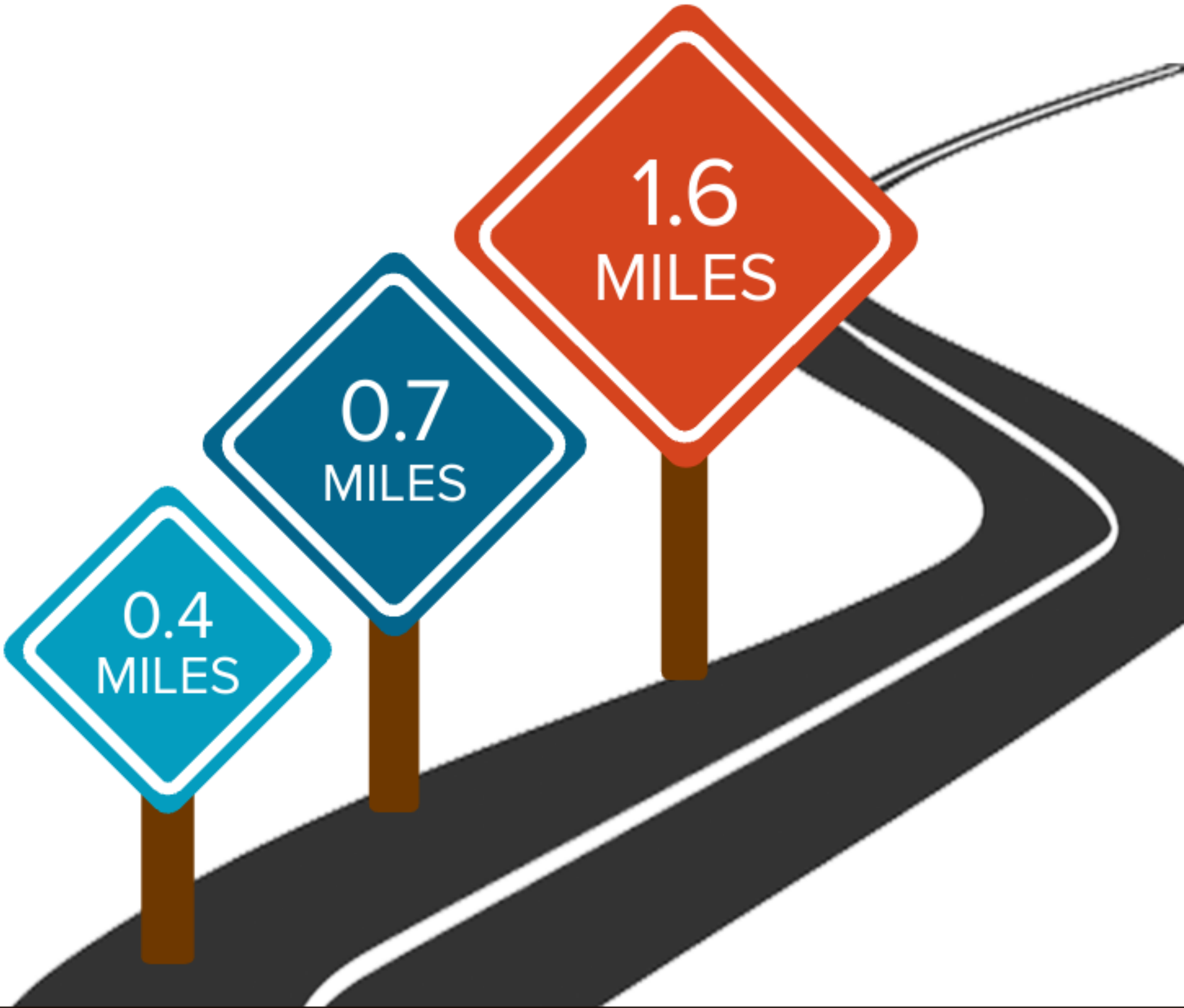

THE GREAT OUTDOORS

This home is located near a variety of outdoor activities.

POPULAR

- PARK  
CHILDRENS WONDERLAND  
(1.4 MILES)
- DOG PARK  
WARDLAW DOG PARK  
(1.4 MILES)
- GOLF COURSE  
BLUE ROCK SPRINGS  
(2.0 MILES)

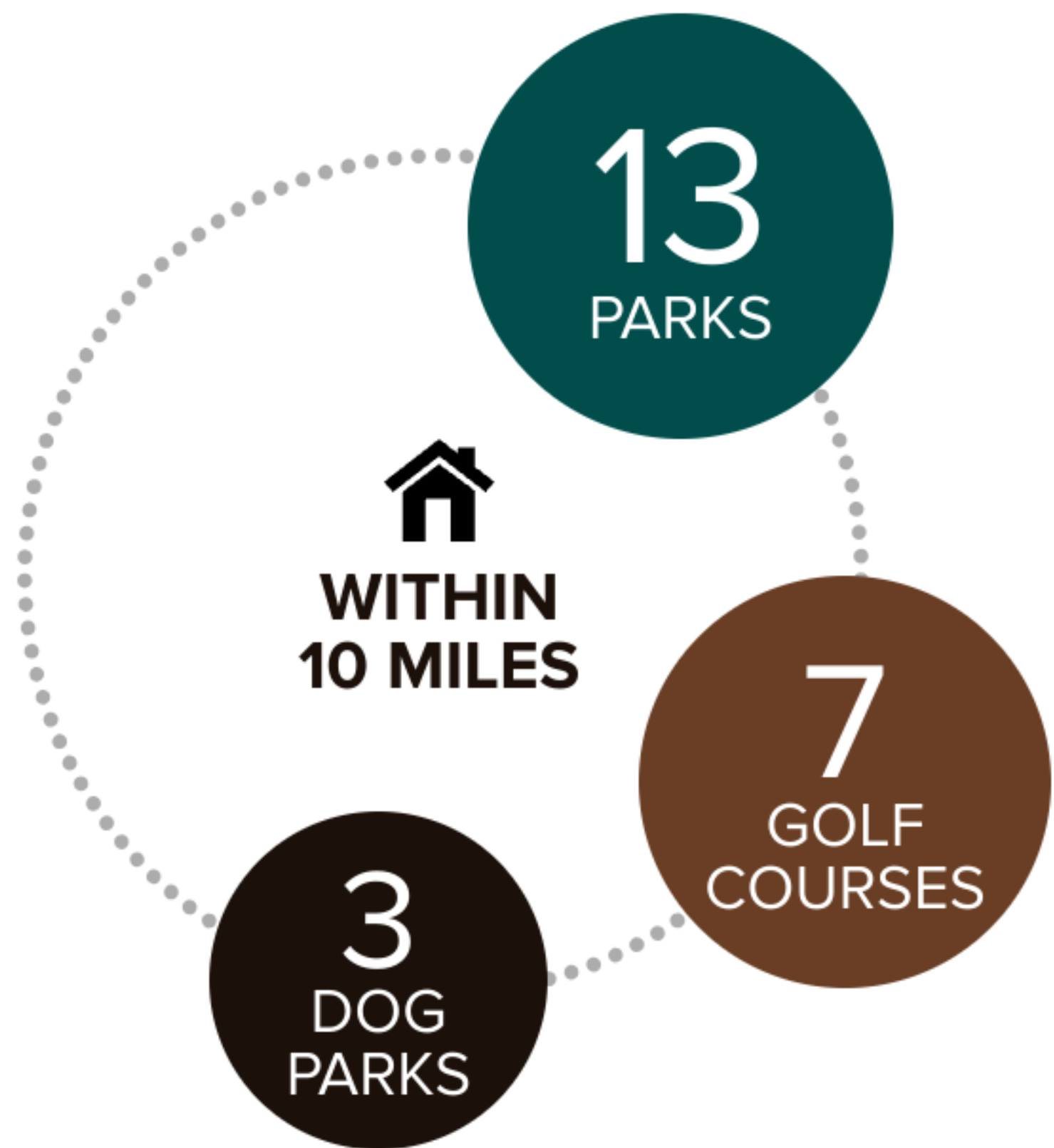

NEIGHBORHOOD EATS

This home is located near **70** moderately priced restaurants and has an **average** variety of cuisines.

BY CATEGORY

|           |    |                       |   |
|-----------|----|-----------------------|---|
| FAST FOOD | 13 | SEAFOOD               | 7 |
| MEXICAN   | 11 | CAFES, COFFEE AND TEA | 7 |
| AMERICAN  | 10 | ITALIAN               | 3 |
| PIZZA     | 9  | BARBECUE              | 3 |
| ASIAN     | 8  | OTHER                 | 8 |

